

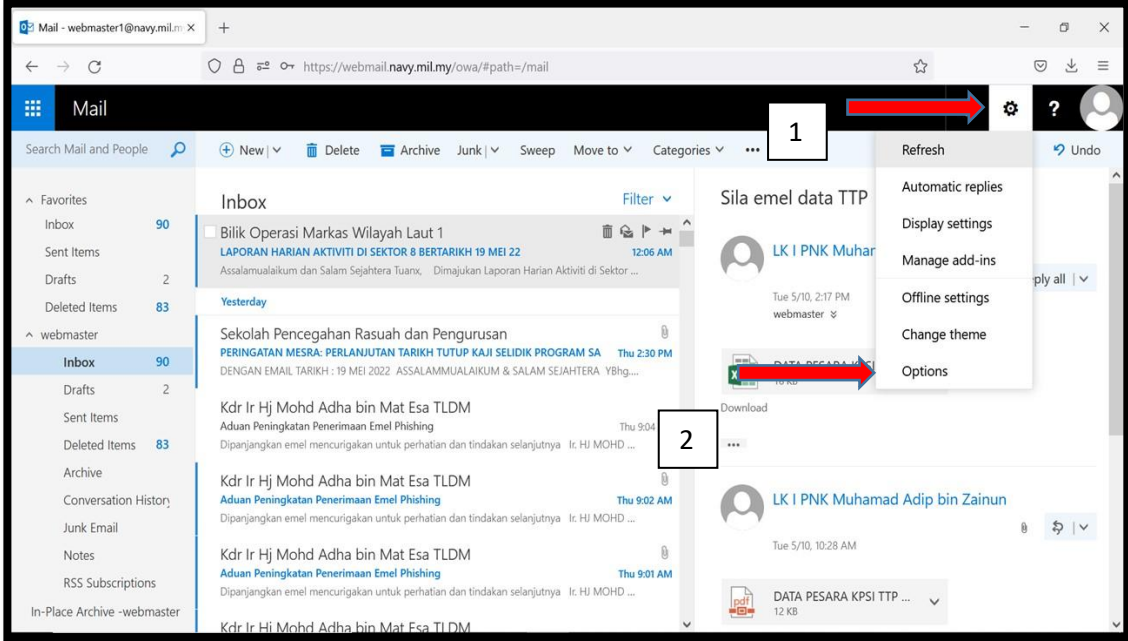

Tatacara Penukaran Kata Laluan Emel Rasmi TLDM

BIL	PAPARAN SKRIN	LANGKAH
1.		<p style="text-align: center;">Skrin 1</p> <p>1. Klik pada butang/icon </p> <p>2. Klik “Options”.</p>
2.		<p style="text-align: center;">Skrin 2</p> <p>1. Klik “General” dan pilih “My account”.</p>

3.

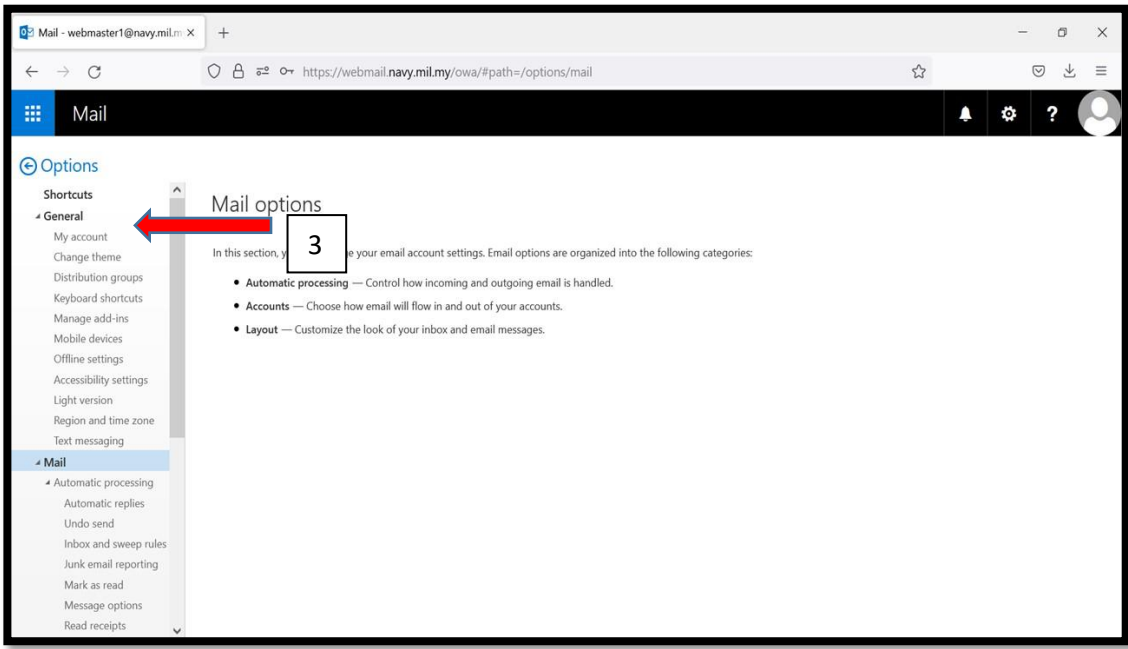
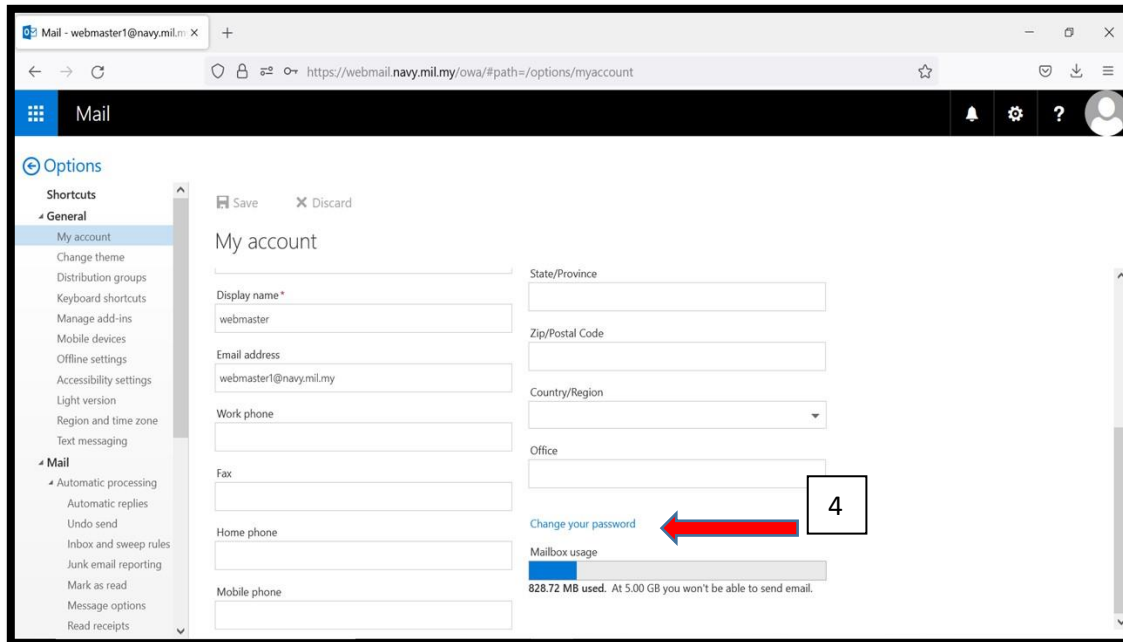

Skrin 3

1. Klik **“Change your password”**.

4.

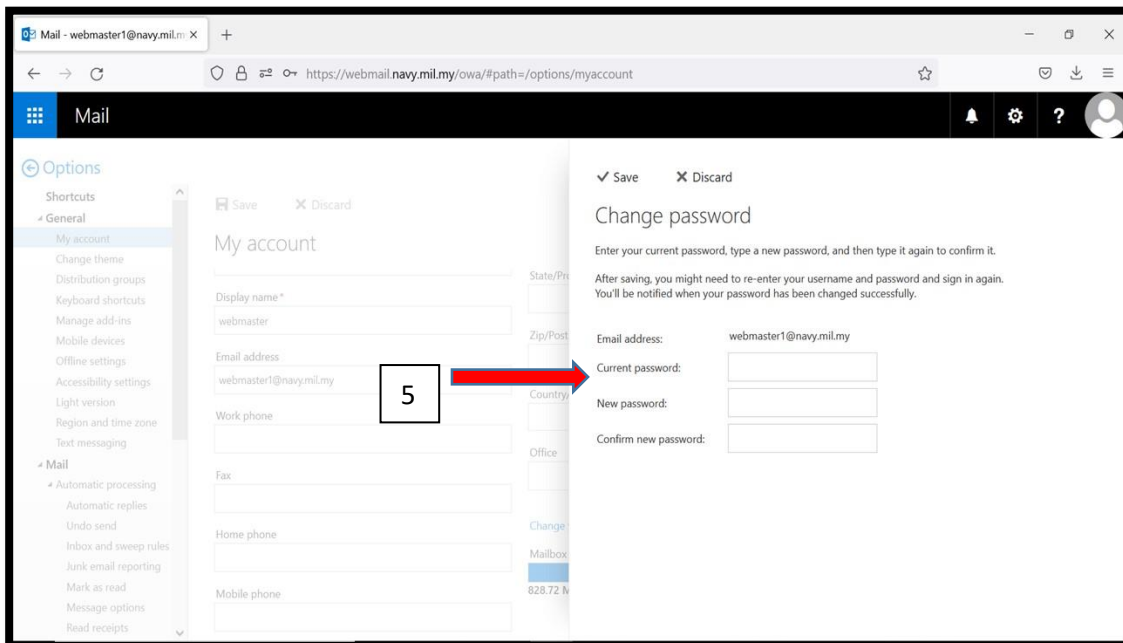

Skrin 4

1. Masukkan kata laluan semasa di ruangan **“Current password”**.

2. Masukkan kata laluan yang baru di ruangan **“New password”**.

3. Masukkan semula kata laluan baru di ruangan **“Confirm new password”**.

4. Klik butang **“Save”**.

5. Kata laluan anda telah berjaya ditukar.